

CROSLEY

USER INSTRUCTION

: FCGH: F99 F9: F 9F5 HCF'

7F<%&FK

1. IMPORTANT SAFETY WARNINGS



R600a

Caution: Risk of fire
Attention, risque d'incendie

WARNING CONCERNING R600a REFRIGERANT

DANGER - RISK OF FIRE OR EXPLOSION. FLAMMABLE REFRIGERANT USED. DO NOT PUNCTURE REFRIGERANT TUBING.

DANGER - RISK OF FIRE OR EXPLOSION. FLAMMABLE REFRIGERANT USED. THE UNIT IS TO BE REPAIRED ONLY BY TRAINED SERVICE PERSONNEL. DO NOT PUNCTURE REFRIGERANT TUBING.

CAUTION - RISK OF FIRE OR EXPLOSION. FLAMMABLE REFRIGERANT USED. CONSULT THE USER'S MANUAL / OWNER'S GUIDE BEFORE ATTEMPTING TO SERVICE THIS PRODUCT. ALL SAFETY PRECAUTIONS MUST BE FOLLOWED.

CAUTION - RISK OF FIRE OR EXPLOSION. DISPOSE OF PROPERTY IN ACCORDANCE WITH FEDERAL AND/OR LOCAL REGULATIONS. FLAMMABLE REFRIGERANT USED.

CAUTION - RISK OF FIRE OR EXPLOSION DUE TO PUNCTURED REFRIGERANT TUBING. FOLLOW HANDLING INSTRUCTIONS CAREFULLY. FLAMMABLE REFRIGERANT USED.

WARNING! DO NOT STORE OR USE GASOLINE OR OTHER FLAMMABLE VAPORS AND LIQUIDS IN THE VICINITY OF THIS OR ANY OTHER APPLIANCE. READ PRODUCT LABELS FOR FLAMMABILITY.

CAUTION - THE UNIT MUST BE POSITIONED AND INSTALLED PROPERLY FOLLOWING THE INSTRUCTIONS CONTAINED IN THIS MANUAL, UNDER THE SECTION "INSTALLATION". WHEN USING AN ELECTRICAL APPLIANCE, YOU SHOULD ALWAYS OBSERVE BASIC SAFETY PRECAUTIONS TO REDUCE THE RISK OF ELECTRIC SHOCK, FIRE OR PERSONAL INJURY.

1. **WARNING** - Keep the ventilation openings in the enclosure free of obstructions. Do not cover the appliance.
2. **WARNING** - Be careful not to damage the refrigerant tubing.
3. **WARNING** - Do not use electrical appliances inside food storage compartments.
4. **WARNING – DANGER:** Risk of trapping children! Before discarding of your old appliance:
 - Take the doors off.
 - Leave the shelves in place to prevent children from climbing easily into the refrigerator.
5. Always unplug the appliance before cleaning and/or servicing.
6. Please make sure that all persons who will use with this appliance are familiar with its operation and safety precautions. It is very important to install the appliance correctly and to follow all safety instructions.

This appliance may not be used by persons (including children) with reduced physical, sensory or mental capacities or lack of experience and knowledge unless instructed by a person responsible for their safety. Children must not play with this unit.

1. IMPORTANT SAFETY INSTRUCTIONS (continued)

7. If the power cord is damaged, it must be replaced by the manufacturer, its service center or a qualified electrician to avoid incidents.
8. Please dispose of the appliance according to local regulations since the appliance uses flammable refrigerant and gas. Before discarding the appliance, remove the doors to prevent children from climbing inside the appliance.
9. This appliance is intended for home use only. Any other use will void the warranty.
10. Do not use this unit to store explosive materials such as aerosol containers with a flammable propellant.
11. Do not use extension cords or 2-prong adapters to connect this appliance to an electrical outlet.

DANGER



IT IS DANGEROUS FOR ANY PERSON OTHER THAN AUTHORIZED SERVICE PERSONNEL TO MAKE REPAIRS ON THIS APPLIANCE.



DO NOT ATTEMPT TO REPAIR THE APPLIANCE YOURSELF. IT IS DANGEROUS TO MODIFY THE SPECIFICATIONS OF THIS PRODUCT OR CHANGE IT IN ANY MANNER. ANY DAMAGE MAY RESULT IN A SHORT-CIRCUIT, FIRE OR ELECTRIC SHOCK.

12. **DANGER** - Risk of fire or explosion. Flammable refrigerant used. To be repaired only by authorized personnel. Do not puncture refrigerant tubes.
13. **DANGER** - Risk of fire or explosion. Flammable refrigerant used. All safety measures must be followed.
14. **DANGER** - Risk of fire or explosion if refrigerant tubes are perforated. Follow the precautionary instructions. Flammable refrigerant used.

2. PRODUCT OVERVIEW

** All images appearing in this instructions manual are for referential purposes only.
For more detailed information, please refer to your appliance.

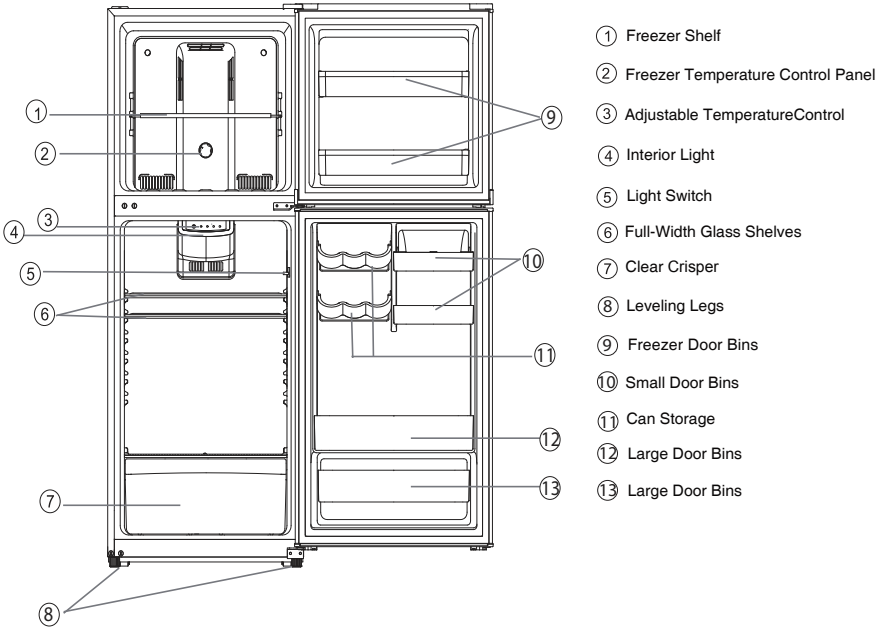

3. INSTALLATION INSTRUCTIONS

RECOMMENDATIONS



WARNING

BEFORE CONNECTING THE APPLIANCE

You should make sure that you have a properly grounded outlet that is compatible with the 3-prong plug on this appliance.

BEFORE STARTING THE APPLIANCE

We recommend that you wait at least two (2) hours before connecting the unit to allow the refrigerant to flow back to the compressor.

BEFORE USING YOUR APPLIANCE

1. Before placing food in your appliance, plug it in and wait 24 hours to ensure it is working properly and that it reaches the correct temperature. Your appliance should not be overfilled.
2. Do not place bottled or sealed liquid products such as beer and soft drinks in the freezer as they may explode.
3. Do not store or place dry ice in refrigerator.
4. It is recommended to place the appliance in a place where the ambient temperature is between 16° C and 32° C. The unit may not operate properly if it remains at a temperature above or below the indicated range.
5. Install your appliance in a dry place, avoid highly humid locations.
6. Do not expose the unit to direct sunlight, rain or frost.
7. Do not install the appliance near heat sources such as stoves, fireplaces or radiators.
8. The appliance requires power supply of 115V / 60Hz AC.
9. Do not use the appliance if the power cord is damaged or the plug is worn.
10. Do not place flammable, explosive, volatile and highly corrosive objects in the appliance as they may cause damage or even fire.
11. Do not place flammable objects near the appliance.
12. This product is a household appliance and should only be used for food storage. According to National standards, refrigerators should not be used for any other purposes, such as storing blood, medicines or biological products.
13. The location of the power outlet must be accessible when installing the appliance and must be grounded.
14. When connecting to an electric outlet, do not use extension cords or power bars as they may overload the system and cause a fire.
15. Plug your appliance into a stand-alone electrical outlet with a voltage matching what is indicated on the rating plate. Do not plug other appliances on the same outlet.
16. Make sure the plug is not flattened or damaged. Failure to do so could result in a short circuit, electrical shock or fire.

3. INSTALLATION INSTRUCTIONS (continued)

3.1 Positioning

When selecting a position for your unit, you should make sure the floor is flat and solid so as to support the load and that the room is well ventilated. Avoid locating your unit near a heat source, e.g. stove, boiler or radiator. Also avoid direct sunlight as it may increase the electrical consumption. Extreme cold ambient temperatures may also cause the unit to not perform properly. This unit is not designed for use in a garage or outdoors. Do not drape the unit with any covering. When installing the unit, ensure that 3 inches of free space is left at both sides, 1 inch at the rear and 1 inch at the top of the unit. This will allow cool air to circulate around the refrigerator and improve its efficiency.

3.2 Door Space Requirements

The unit's door must be able to open fully as shown. Please refer to the measurements below and to the illustration.

$W \times D \geq 990 \times 1025 \text{ mm (39" x 40 1/4")}$

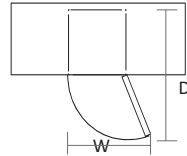

3.3 Levelling the Unit

To make this adjustment, use the two levelling feet at the front of the unit. If the unit is not level, the door and magnetic seal alignments will not meet up properly. Drop down from the top, clockwise and counterclockwise, loosening or tightening.

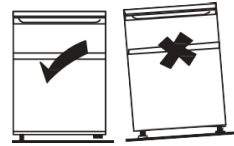

3.4 Cleaning before use

Wipe the inside of the unit with a light solution of baking soda and water. Then rinse with warm water using a wrung-out sponge or cloth. Wash the shelves and vegetable crisper bins in warm soapy water and dry completely before replacing in the unit. Clean the exterior of the unit with a damp cloth. If you require more information refer to the CLEANING section.

3.5 Interior Accessories

Various glass shelves and/or plastic storage bins are included with your appliance - different models have different combinations.

You should always slide one of the full-sized glass storage shelves into the lowest set of guides, above the fruit and vegetable bins and keep it in this position. To do this, pull the storage shelf forward until it can be moved upwards or downwards and then removed. Do the same in reverse if you wish to insert the shelf at a different height.

In order to make full use of the volume of the fresh food storage compartment and of the frozen-food storage compartment, the user can remove one or more shelves and/or drawers out of the appliance, to better suit your needs.

4. REVERSING THE DOORS

Tool required: Philips screwdriver, flat bladed screwdriver, hexagonal spanner.

- Ensure the unit is unplugged and empty.
- To take the door off, it is necessary to tilt the unit backwards. You should rest the unit on something solid, so that it will not slip during the door reversing process.
- All parts removed must be saved to do the reinstallation of the door.
- Do not lay the unit flat as this may damage the coolant system.
- It's better that 2 people handle the unit during the assembly.

FREEZER DOOR

1. Unscrew the top hinge cover (see figure 1).
2. Remove the top hinge cover.
3. Loosen the top hinge screws with Phillips head screwdriver.
4. Adjust the door or put a spacer in between and then tighten the screws.
5. Replace the top hinge cover.
6. Move the hinge cover from left side to right side.

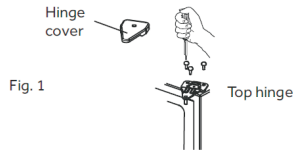

REVERSING THE DOOR SWING

Left/right door opening method:

This product allows you to reverse the door opening from left to right and back. You can select your preference of door opening by following the procedure to make the change.

Dismantling (see figures 1 and 2):

1. Close shut the refrigerator and freezer doors with adhesive tape on both sides to hold the doors in place.
2. As shown in figure 1, remove the hinge cover screw on the upper part of freezer door with a Phillips head screwdriver. Then remove the three screws that hold the hinge. Take out the hinge by pulling it vertically and set it aside in a safe place.
3. Remove the adhesive tape on freezer door, lift and take off the door and carefully set it aside.
4. Remove all the screws of the middle hinge, lift and take off the middle hinge and keep all hinge parts in a safe place.

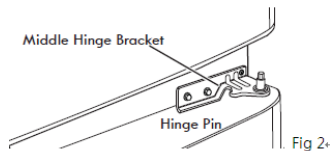

4. REVERSING THE DOORS (continued)

REVERSING THE DOOR SWING (continued)

5. Move the hinge hole covers from left side to right side.

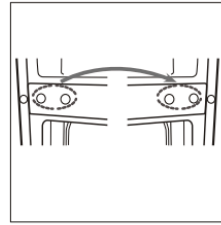

Fig3

6. After removing the refrigerator door hinge, remove the screw cover from the upper left side of refrigerator door frame, then insert the cover into the hinge hole on the right of door frame.
7. Remove the adhesive tape on refrigerator door, lift and take off the door then carefully set it aside.
8. Tilt the refrigerator on a 45-degree angle to have access to the bottom front.
9. Remove both left and right front feet from bottom. Then remove all screws on the bottom door hinge. Set aside the screws and leveling legs in safe place.



Fig 4

REINSTALLATION

1. Take a new bottom hinge from the user's manual bag. Align the holes in the bottom hinge to the corresponding holes on the left side of the cabinet. Insert and tighten the screws. Reinstall both front feet. Install the short leveling leg on the left side and the long leveling leg on the right side.
2. To install the refrigerator door: Line up the left bottom hole of the refrigerator compartment door over the bottom hinge pin. Move door forward to make sure it is straight and aligned with the bottom hinge. Ensure the door is aligned horizontally and vertically so that the seal is closed on all sides before finally installing and tightening the middle hinge. Install and tighten the middle hinge again and turn the hinge axle until it completely enters the door body. Secure it with the screws.

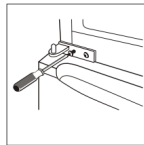

Fig 5

3. To install freezer door: Line up the left bottom hole of the door over the center hinge's middle pin. Move door forward to make sure it is straight and aligned with the freezer compartment. Ensure the door is aligned horizontally and vertically so that the seal is closed on all sides before finally tightening the top hinge. Take the new upper hinge from the user's manual bag, turn the hinge axle until it completely enters the door body. Screw the top hinge.
4. Install the top cover and screw it to the top of unit.

5. OPERATION

Keys Operation

The keys in the display layout are referred to in the following figure:

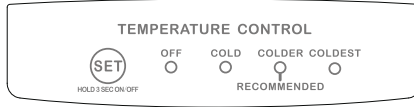

5.1 Display and description

- SET button:** Press to change the refrigerator setting from 1 (cold) to 3 (coldest).
LED indicator lights: Light up to show the current refrigerator setting.

5.2 Refrigerator Temperature Controls

Your refrigerator will automatically maintain the temperature level you select. The temperature control has three (3) settings:

COLD is the warmest setting, *COLDER* is the recommended setting, *COLDEST* is the coldest setting.

You can change the temperature setting amongst "*COLD*", "*COLDER*" and "*COLDEST*" by pushing the "*SET*" button. At first, set the panel to the "*COLDER*" setting and allow 24 hours before adjusting the temperature to your needs.

The power can be switched off by pressing the "*SET*" button for three (3) seconds and the "*OFF*" indicator light will turn on. To switch the power back on, press the "*SET*" button again for another three (3) seconds.

5.3 Freezer Temperature Control

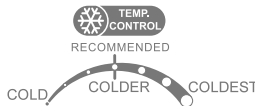

- Your unit has one vent control for regulating the temperature in the freezer compartment. The temperature control is located on the center of the freezer compartment's interior back panel.
- The first time you turn the unit on, adjust the temperature control knob to "*COLDEST*" and let the unit run for at least two (2) hours before storing food inside. This will ensure that the freezer's cabinet is thoroughly chilled before food is put in.
- The freezer temperature control ranges from "*COLD*" (the warmest) to "*COLDEST*" (the coldest). Adjust this control to get the desired temperature. The recommended setting is "*COLDER*" (halfway between "*COLD*" and "*COLDEST*").

6. CLEANING

6.1 Defrosting

This appliance does not require defrosting as it is specially equipped with a 'Frost-free' type cooling system. The defrost water is routed into a pan located near the compressor where it then evaporates.

6.2 Cleaning the Interior and the Exterior of the Unit

- ◆ Remove all the shelves and the produce bins. To remove the produce bins, first remove the lower door shelf.
- ◆ Clean the inside of the unit with a mild solution of baking soda and water and then rinse with warm water using a wrung-out sponge or cloth. Wipe completely dry before replacing the shelves and the produce bins.
- ◆ Use a damp cloth to clean the exterior then wipe with a standard furniture polish. Make sure that the door is closed to avoid the polish getting onto the magnetic door seal or inside the unit.

6.3 Cleaning Tips

Condensation may appear on the outside of the unit. This may be due to changes in room temperature. Wipe off any moisture residue with a clean cloth. If the problem persists, please contact a qualified technician for assistance.

7. MAINTENANCE

7.1 Changing the Internal Light

We do not recommend that you change the LED light yourself. Please contact an authorized service center.

7.2 Care When Handling / Moving Your Unit

Hold the unit around its sides or its base when moving it. Under no circumstances should it be lifted by holding the top end and edges.

The condenser is located at the bottom of the refrigerator; please be careful. Keep the bottom end dry during use, processing and handling.

Before moving the unit, make sure that the surface on which it will rest is perfectly flat and as level as possible and solid enough to hold the weight of the unit and its contents.

7.3 Servicing

The unit should be serviced by an authorized technician and only genuine spare parts should be used. Under no circumstance should you attempt to repair the unit yourself. Repairs carried out by inexperienced persons may cause injury or serious malfunction. Contact a qualified technician.

7.4 Switching Off Unit for Long Periods of Time

When the unit is not in use for a long period of time, disconnect it from the main source of power supply, empty out its contents and clean the appliance, leaving the door ajar to allow air out and to help prevent odor.

8. WARRANTY

Your appliance is covered by a **one (1) year limited warranty**. For one year from your original date of delivery, **Corbeil Electrique Inc.** will repair or replace any part of this appliance that proves to be defective in materials or workmanship when such appliance is installed, used and maintained in accordance with the provided instructions. Furthermore, the sealed refrigeration system (compressor, condenser, etc.) of your appliance is covered by a **one (1) year limited warranty**.

EXCLUSIONS

This warranty does not cover the following:

- Product with original serial numbers that have been removed, altered or cannot be readily determined.
- Product that have been removed outside of Canada.
- Rust on the interior or exterior of the unit.
- Food loss due to an appliance failure.
- Products that are used for commercial purposes.
- Service Calls which do not involve malfunction or defects in materials or workmanship or for appliances that are not used in ordinary households or used for purposes other than in accordance with the provided instructions.
- Expenses for making the appliance accessible for servicing, such as removal of trim, cupboards, shelves, etc., which are not a part of the appliance.
- Service Calls to repair or replace appliance consumables, knobs, handles or other cosmetic parts.
- Pickup and delivery costs; your appliance will be repaired at home.
- Damages to the finish of appliance or home incurred during transportation or installation, including but not limited to floors, cabinets, walls, etc.
- Damages caused by: services performed by unauthorized Service Centers; use of parts other than genuine parts or parts obtained from persons other than authorized Service Centers; or external causes such as abuse, misuse, inadequate power supply, accidents, fires, or acts of God.

DISCLAIMER OF IMPLIED WARRANTIES; LIMITATION OF RECOURSES

THE CUSTOMER'S SOLE AND EXCLUSIVE RECOURSE UNDER THIS LIMITED WARRANTY SHALL BE REPAIR OR REPLACEMENTS AS PROVIDED HERE. CLAIMS BASED ON IMPLIED WARRANTIES, INCLUDING WARRANTIES OF MERCHANTABILITY OR FITNESS FOR A PARTICULAR PURPOSE, ARE LIMITED TO ONE (1) YEAR OR THE SHORTEST PERIOD ALLOWED BY LAW.

Corbeil Appliances Inc. SHALL NOT BE LIABLE FOR CONSEQUENTIAL OR INCIDENTAL DAMAGES SUCH AS PROPERTY DAMAGE AND INCIDENTAL EXPENSES RESULTING FROM ANY BREACH OF THIS WRITTEN LIMITED WARRANTY OR ANY IMPLIED WARRANTY. SOME PROVINCES DO NOT ALLOW THE EXCLUSION OR LIMITATION OF INCIDENTAL OR CONSEQUENTIAL DAMAGES, OR LIMITATIONS ON THE DURATION OF IMPLIED WARRANTIES, SO THESE LIMITATIONS OR EXCLUSIONS MAY NOT APPLY TO YOU. THIS WRITTEN WARRANTY GIVES YOU SPECIFIC LEGAL RIGHTS. YOU MAY ALSO HAVE OTHER RIGHTS THAT VARY FROM PROVINCE TO PROVINCE.

9. TROUBLE SHOOTING

The following issues can be handled by the user. Please call the after-sale service department only if they are not resolved.

Non operational	Check if the appliance is plugged and connected to power; Low voltage; Failure power or tripping circuit.
Odors	Odorous foods should properly wrapped; Check if foods are spoiled; Check if the interior needs cleaning.
Long-term operation of compressor	It is normal that the appliance operates for a longer period of time in summer when the ambient temperature is higher; Do not store too much food in the appliance at one time; Do not store cooked foods until they are well cooled; Frequent opening of the door will cause compressor to start.
Light does not work	Check if the appliance is connected to power; Check if light is damaged.
The refrigerator door does not close properly	The door is blocked by food packages; The compartments are overstuffed; Appliance is not level.
Loud noises	Check if food is properly set flat; Check if the appliance is level; Check if the parts are properly installed.

9.1 Tips

- ◆ It is normal for the refrigerator enclosure to give off heat during operation especially in summer; this is caused by emissions from the compressor.
- ◆ Condensation can be detected on the exterior surface and door seals of the freezer when the ambient humidity is high; this is a normal phenomenon and the condensation can be wiped off with a dry towel.
- ◆ Humming sounds can be generated by a functioning compressor especially when starting up or shutting down.

